

AVEVA Engage Demonstrator FAQs

Last updated: 17 October 2016

How do I use the Demonstrator app?

There is a quick start user guide accessible from within the app. Simply click on the ? icon in the toolbar to discover how to navigate the model, perform measurements, run Visual Queries and access information and documents related to the selected engineering objects.

I can't install the app

Please check your machine meets the hardware and software requirements:

Operating System	Microsoft Windows 10 Enterprise Edition (64bit).
Minimum System CPU	Intel 64bit high-end CPU. E.g. Intel Core i7 ~ 3GHz.
Minimum System RAM	8 GB.
Minimum Graphics Card	NVIDIA Quadro K2000 equivalent or better. DirectX 11.1, shader model 5 capable. 2GB Graphics Memory.
Display	Large ten point multi-touch screen (>27").

I have installed the app but it won't run

Please check your machine meets the hardware and software requirements outlined in the "I can't install the app" section above.

Performance is slow

Please check your machine meets the hardware and software requirements outlined in the "I can't install the app" section above.

Part of the 3D view is flickering

Please check your machine meets the Minimum Graphics Card requirements outlined in the "I can't install the app" section above.

Install the latest driver for your graphics card from your graphics card vendors' web site.



The application user interface is not occupying the entire screen and/or there is misalignment of objects in the 3D view.

Scaling issues may occur when the size of “text, apps and other items” is set to a value greater than 100%.

Resolve this issue by changing size of “text, apps and other items” to 100%:

- Click “Start”;
- Type (search for) “Change the size”;
- Click “Change the size of apps on the screen”;
- Slide the “Change the size of apps and other items” slider control to 100%;
- Close the “Customize your display” window.

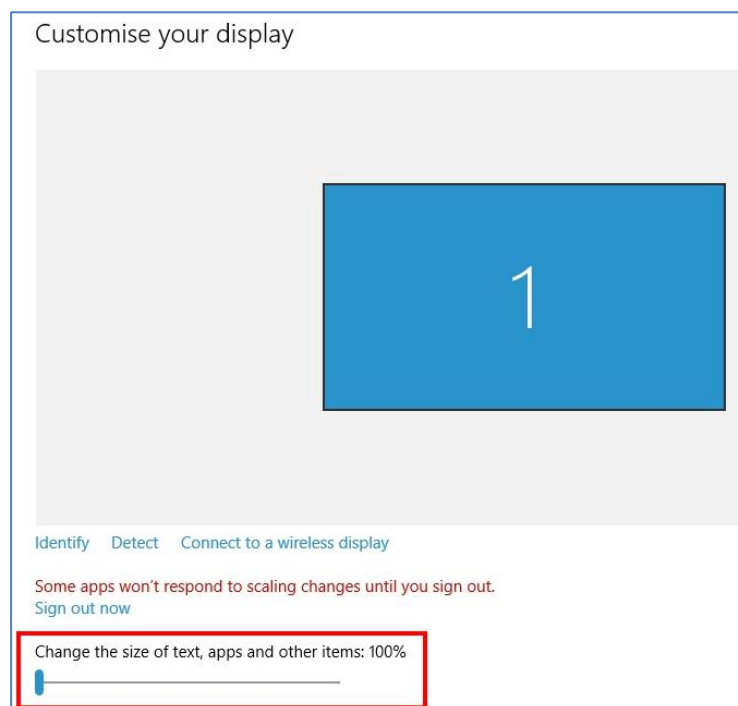
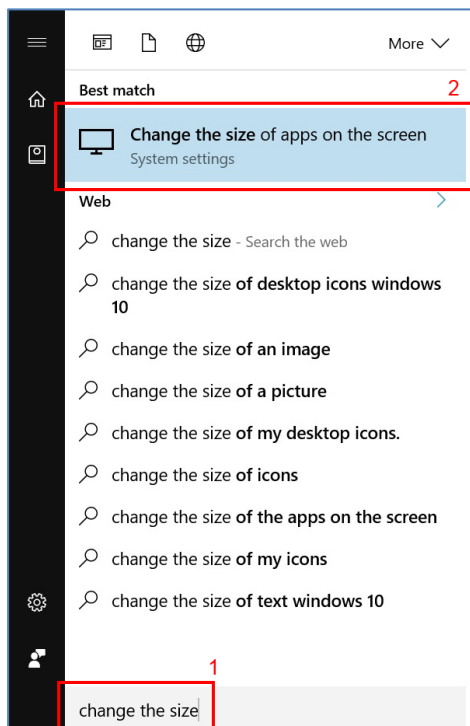

Can I load my own models?

This demonstrator app is fixed to a single demo model. To load your own models and digital asset data, please contact AVEVA for details of the full version of AVEVA Engage.

Where can I find out more information about AVEVA Engage?

Please email product.marketing@aveva.com - who may put you in contact with your local sales team.





Can I create my own visual queries?

Visual Queries have been pre-loaded and are therefore fixed in the Demonstrator. For information on Visual Query functionality, please contact AVEVA for details of the full version of AVEVA Engage.

What AVEVA NET documents can I view in the Demonstrator?

We only show PDF and SVG documents in the Demonstrator. For information on supported AVEVA NET documents, please contact AVEVA for details of the full version of AVEVA Engage.

